

UNPAINTED UNASSEMBLED FIGURE / 未塗装未組立キット(フィギュア)



メガミデバイス  
MEGAMI DEVICE

2/1 SCALE UNPAINTED UNASSEMBLED FIGURE

# ASRA ARCHER

## Modelers Edition

アスラ キュウヘイ  
[朱羅 弓兵 モデラーズエディション]

# Instruction Manuals

[English / 英語版]

# Product Features

This product is an unassembled variant of the “Pre-painted, Pre-assembled PVC Statue ASRA ARCHER” that was released in May 2023.

Unlike other Kotobukiya statue and model kit products, the design is intended to be assembled by factories and not end users. Because of that, some parts require manual adjustment of their fit and shape using tools by end users.

Assembly requires some knowledge and skills in the use of the materials, adhesives, and necessary tools.

Please enjoy with these features in mind.

■ The materials used are mostly PVC and ABS. Please use instant adhesives for gluing the parts together.

- If the parts are both made of ABS, specialized ABS adhesives can be used as well.

■ Almost all parts will have unfinished sprue marks and plastic burrs from the molding process. Please be aware of the following.

- Due to their shapes, it may be unclear which parts require removal. Please make sure to attempt temporary assembly to confirm if adjustment is necessary before sanding, cutting, or gluing.
- Please use a sturdy set of nippers (cutter knives and carving knives can be used as well) for removal of unnecessary materials. Use of thin and precise blades like those on precision nippers may damage the blade.
- Please be careful not to injure yourself when making adjustments using these bladed tools.

■ Certain types of thinners in the paint may attack and degrade the ABS plastic, leading to more brittleness and overall weakening of the parts.

- For painting the ABS parts, please use surfacer or primers for model kits to form a protective coating before applying paint.
- Even after forming the protective coating, please do not use paints with a lot of thinner to avoid chemical degradation.



【Kotobukiya Official Website: How to Paint ABS Parts】

URL : <https://www.kotobukiya.co.jp/en/page-21029/>

■ PVC is a soft material, and can deform if enough force is applied. Such deformations can be corrected by heating the parts using hair dryers or hot water, and then bending it back to shape.

- When doing so, please use warm water at a temperature that you can touch. Be aware of burns.

- After about 10 seconds the parts will become soft, depending on the temperature. Be sure to check the progress, especially thin portion of the parts as they become soft faster.

■ When painting PVC parts, please be aware of the following.

- Usually paint thinners should not affect the overall integrity of the parts but may cause degradation on the surface. Do not expose the parts to paint thinners for a long time.
- Paint layers on statues tend to be less durable than those on plastic model kits. We recommend using primer to treat the surface for a more durable paint layer.
- Bending, pushing, or otherwise deforming the parts may cause the layer to peel off. Please be careful during assembly. Also, standard model-kit paint tends to have very limited elasticity after drying and will not conform to any adjustments.



URL : <https://www.kotobukiya.co.jp/blog2/megami/article/detail/252/>

Unfortunately the guide article is in Japanese only.

We apologize for your inconvenience.

# A Assemble Head 1

1



2

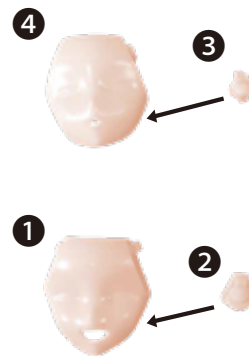

3

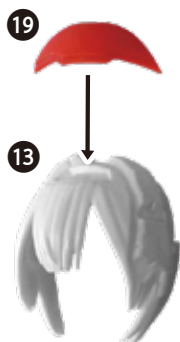

4

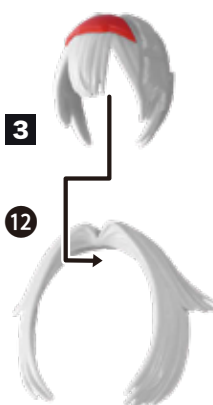

5

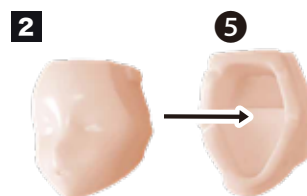

Leave unglued to exchange face parts.

6

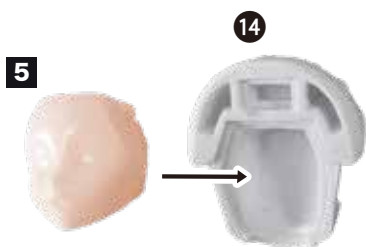

7



Leave unglued to exchange face parts.

Magnets are not included with this product. Please prepare magnets or consider other methods for adhesion during assembly.

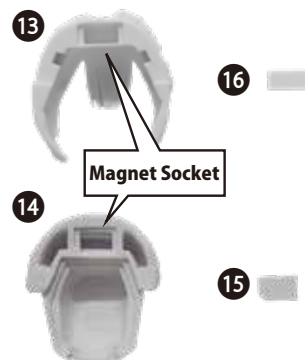

8

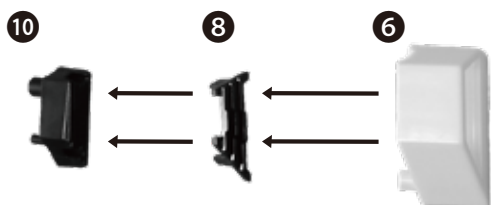

9

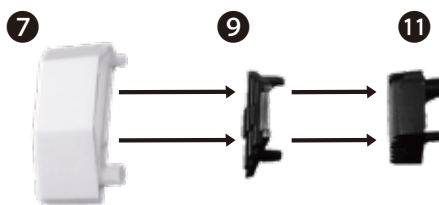



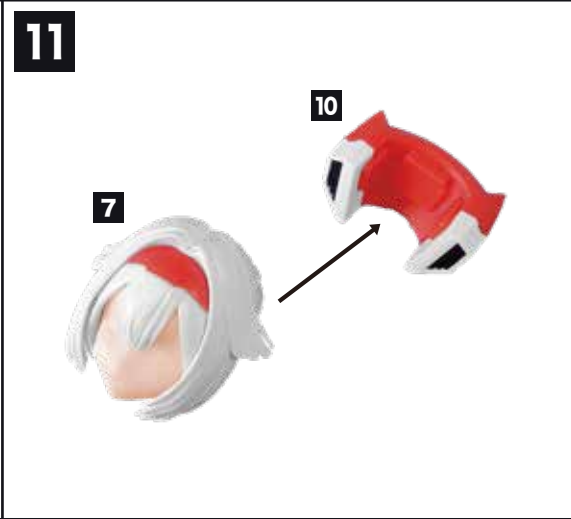
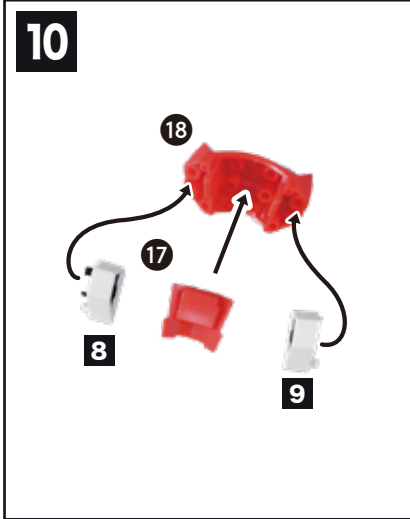

## B Assembly Head 2

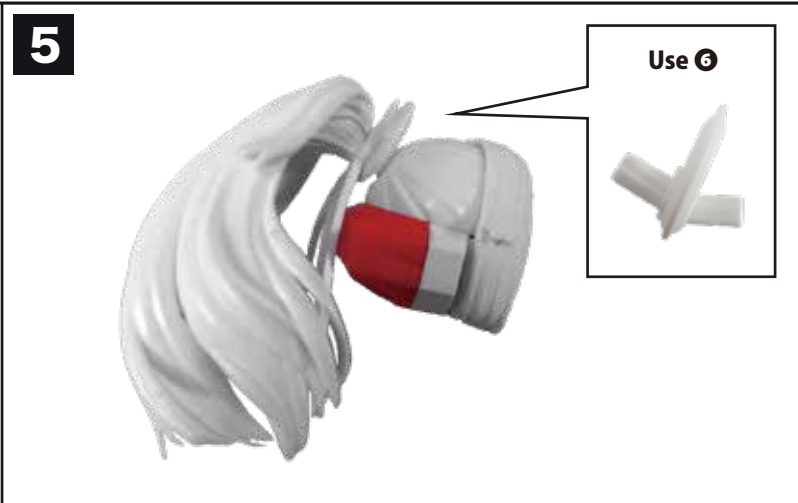
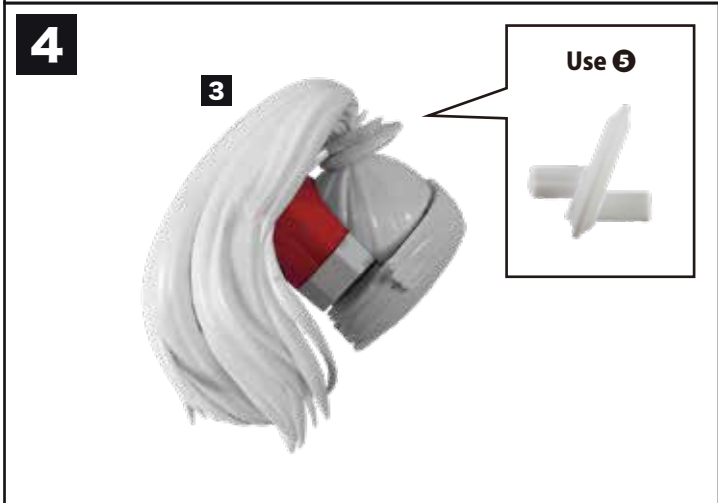
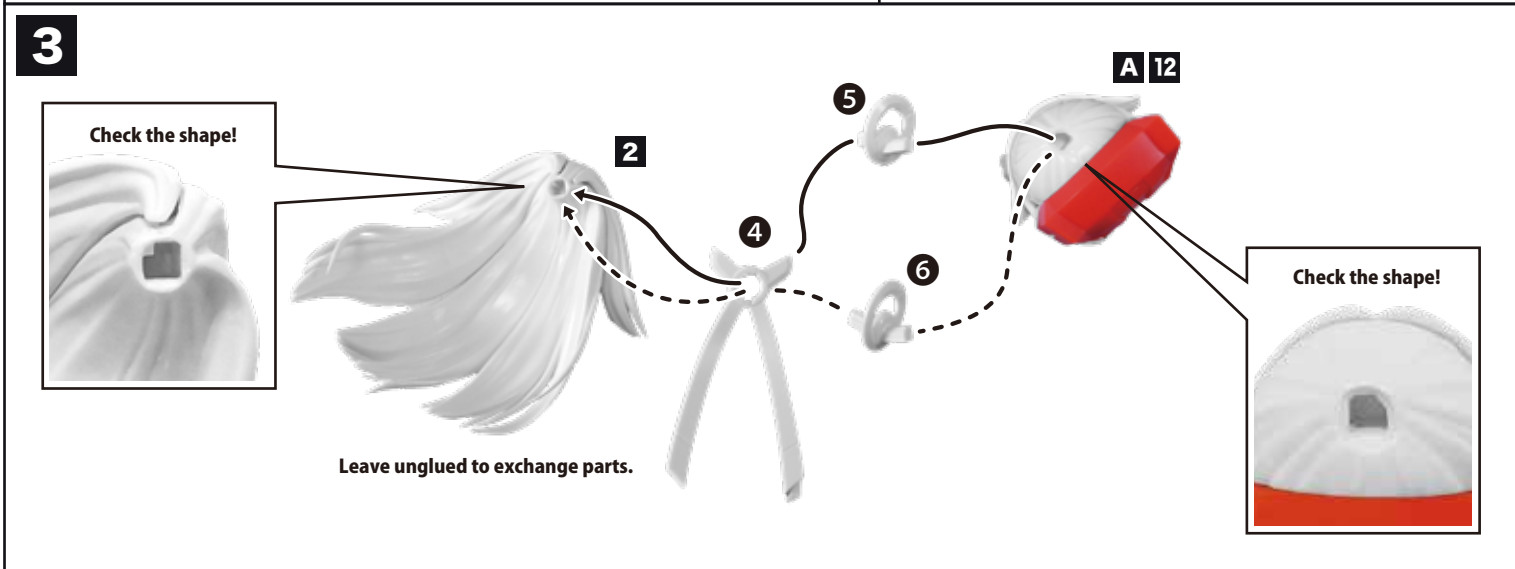
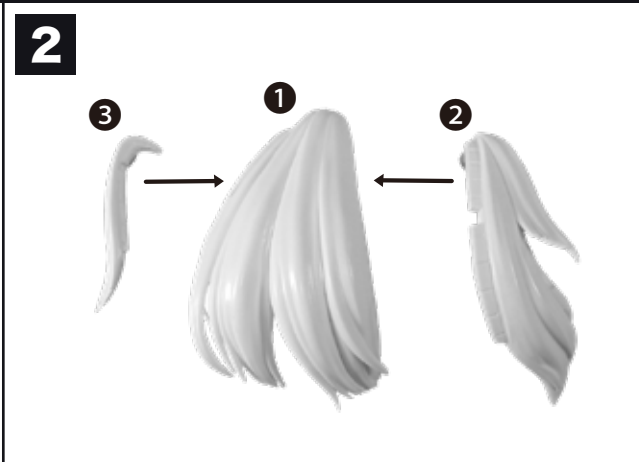
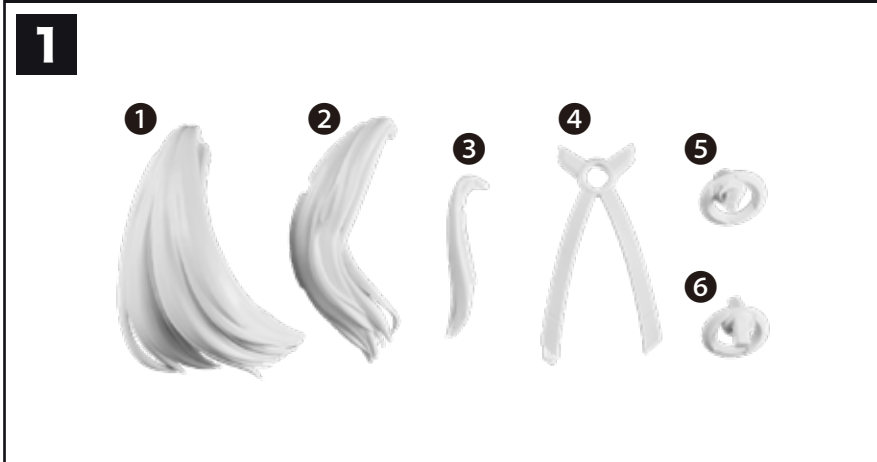

## C Assemble Torso

1

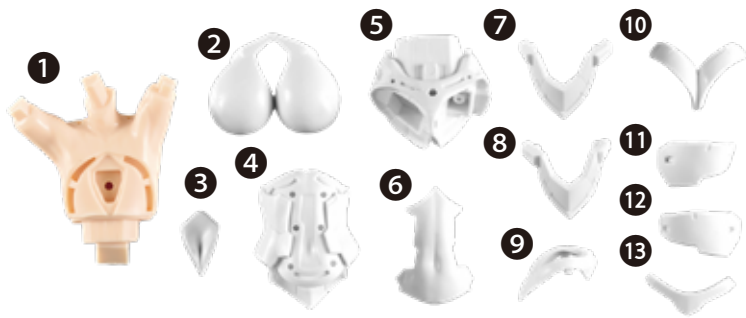

2

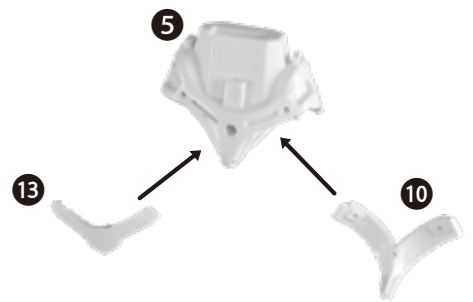

3

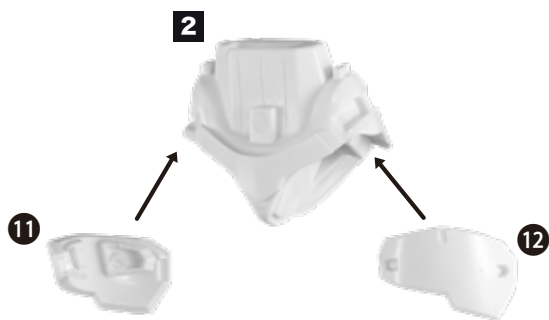

4

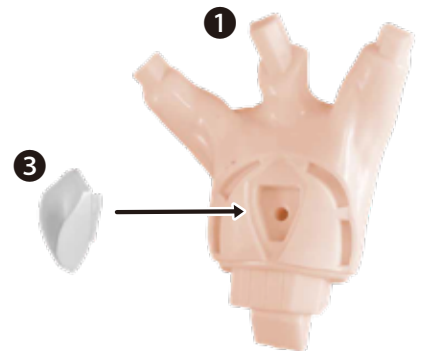

5

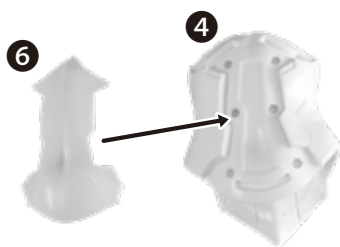

6

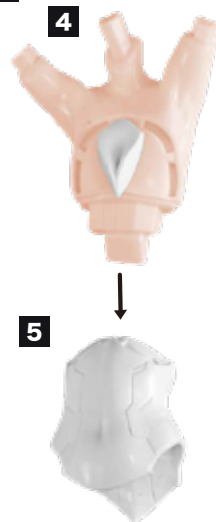

7

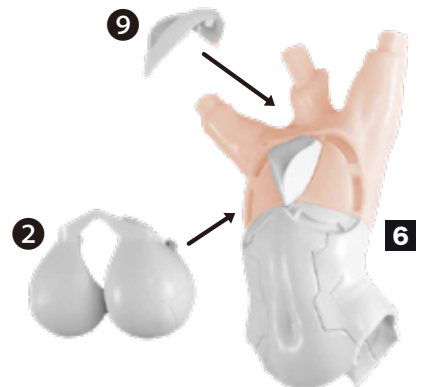

8

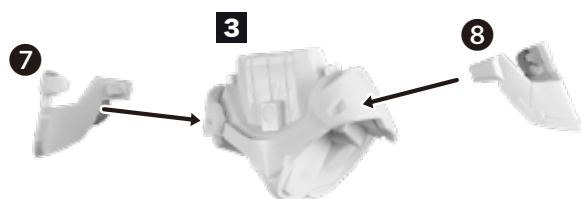

9

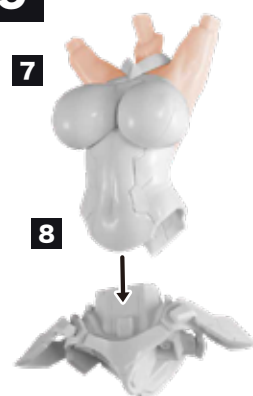

10



## D Assembly Waist

1

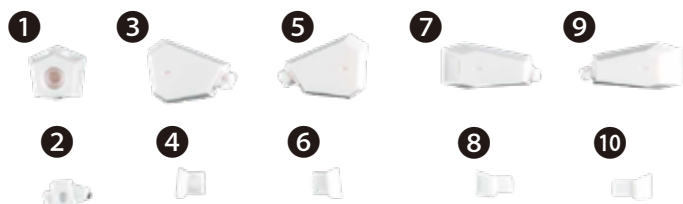

● Whole Body Mold Part ② x1

2

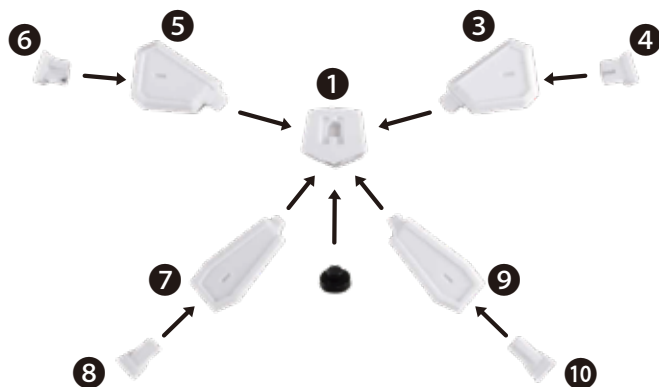

3

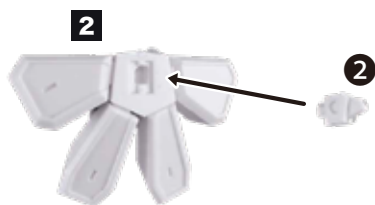

4

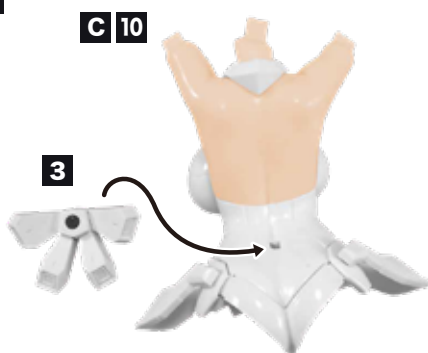

5



## E Assemble Hand

1



2

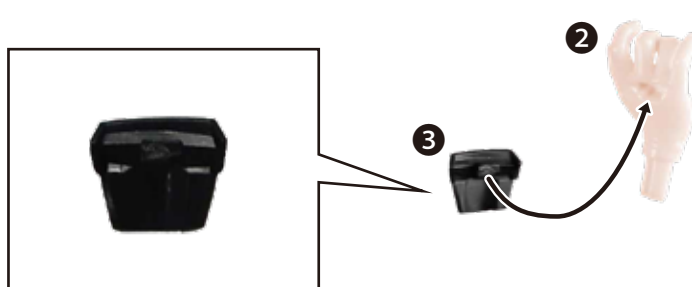

3

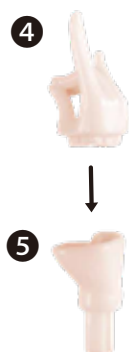

4



## F Assemble L Arm

1



2

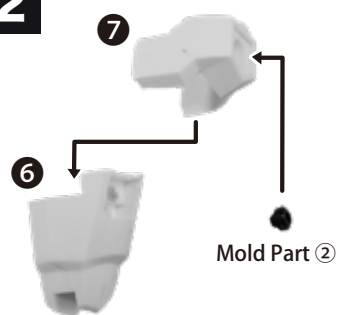

3

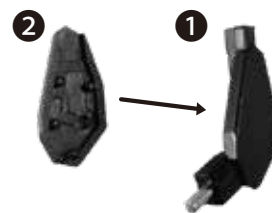

4



5



6

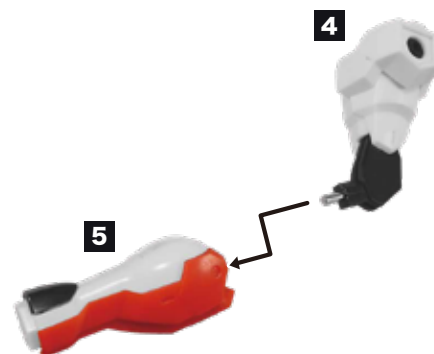

7

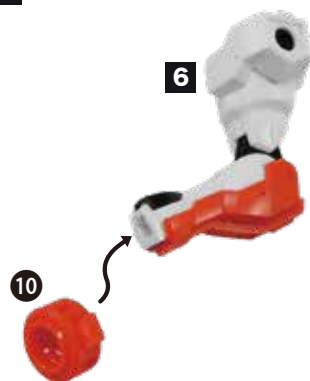

8

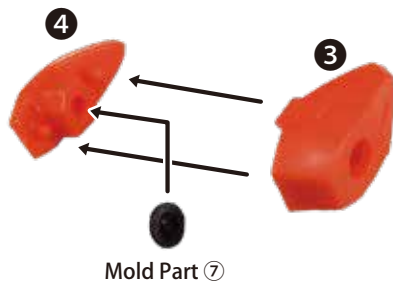

9



10

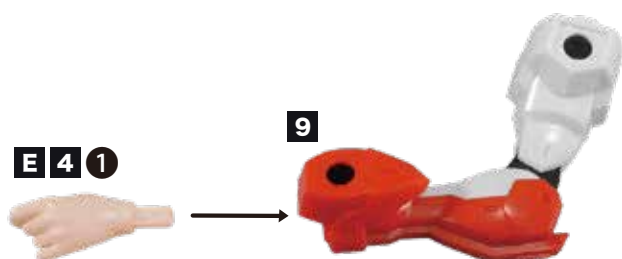

11



## G Assemble R Arm

1



2

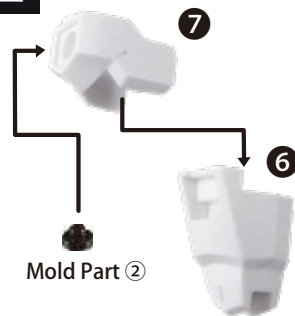

3

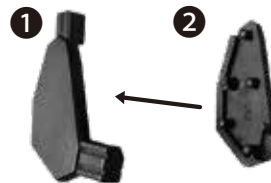

4



5

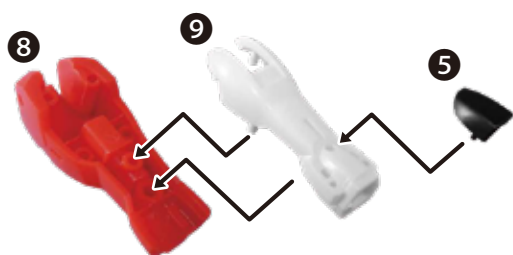

6

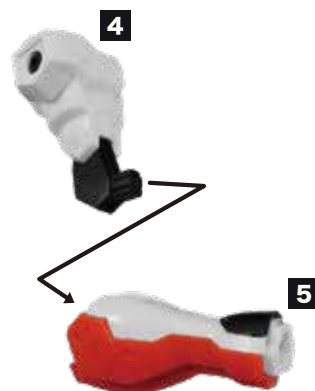

7

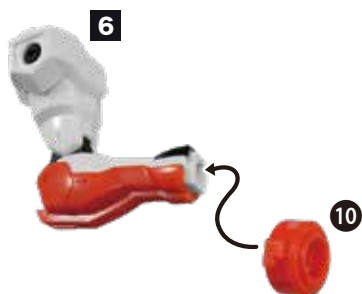

8

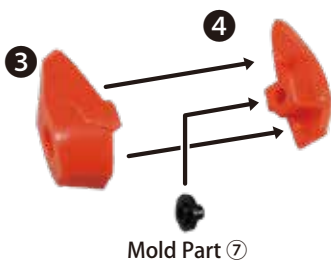

9



10

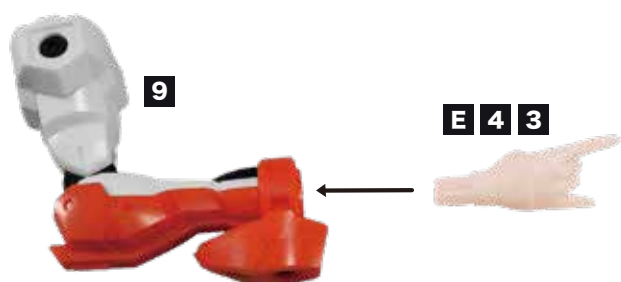

11



## H Assemble Right Leg

1

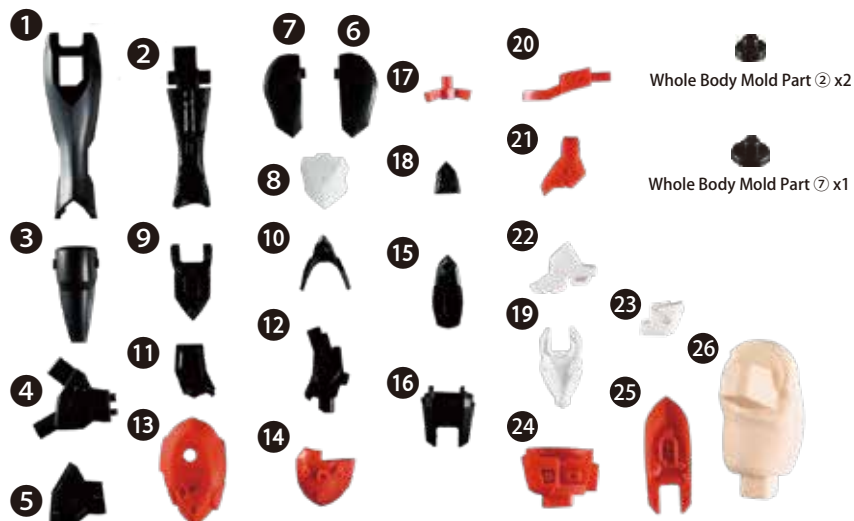

2

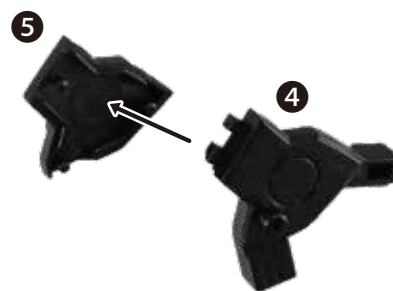

3

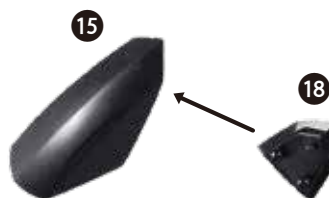

4

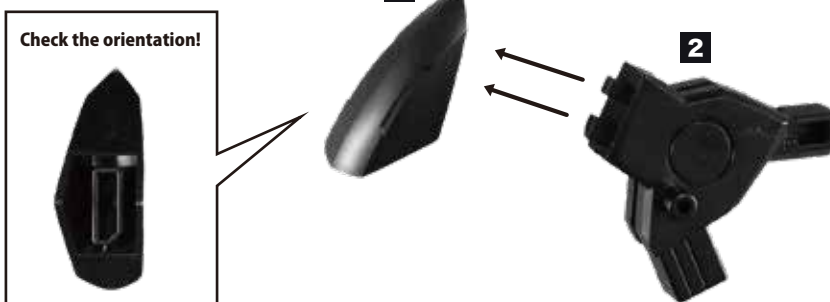

5

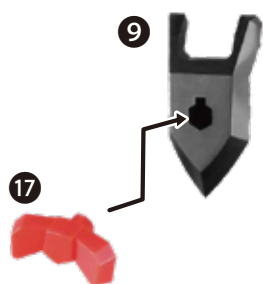

6

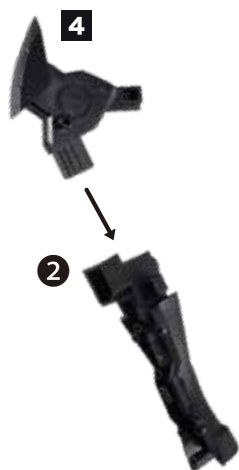

7

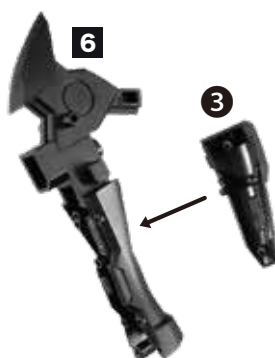

8

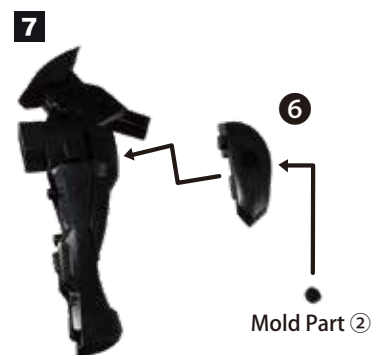

9

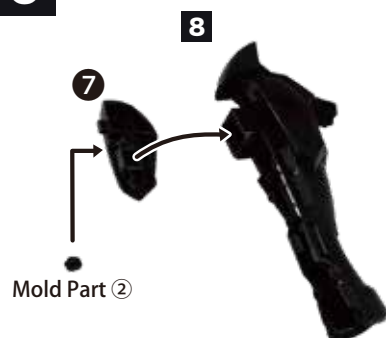

10



11



Leave unglued to exchange parts.



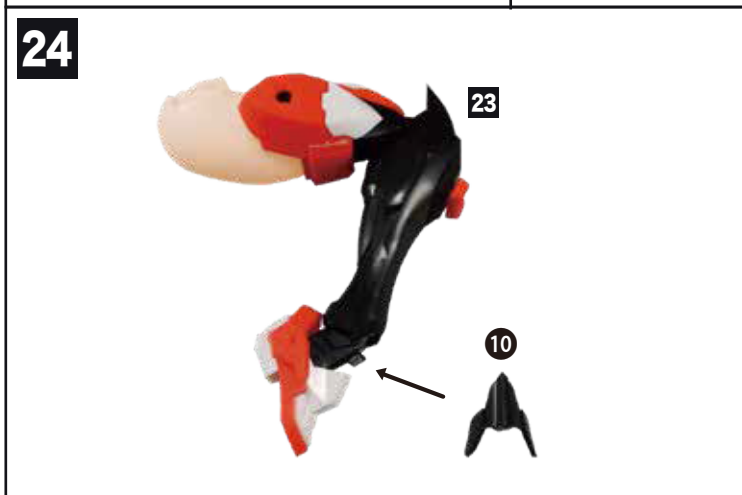
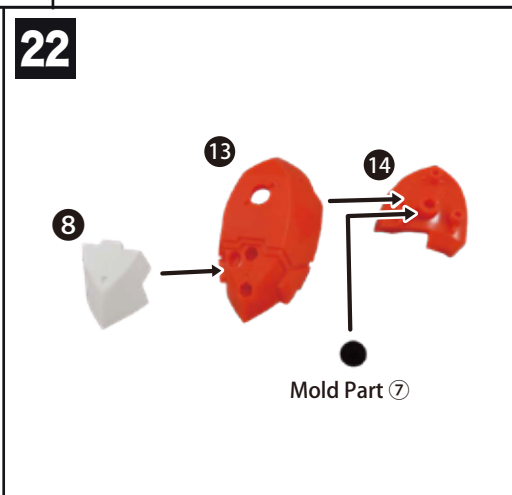
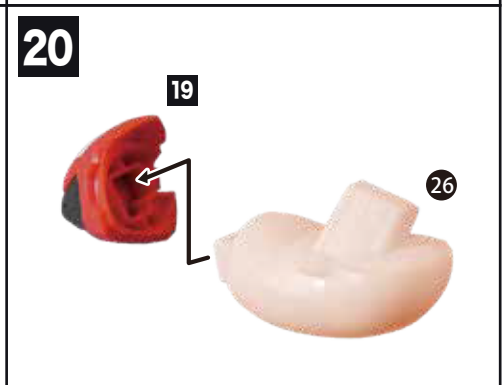
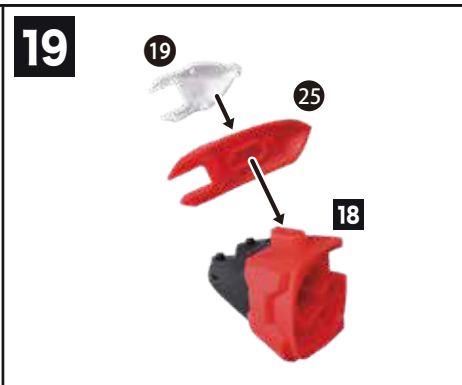
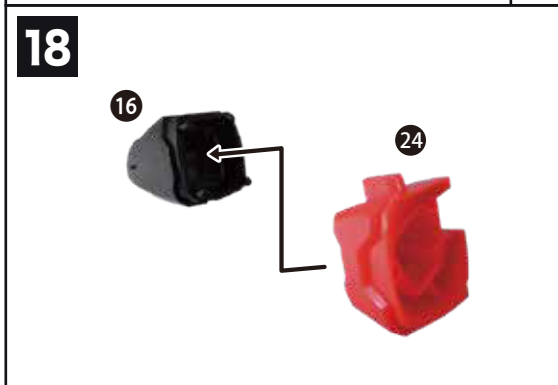
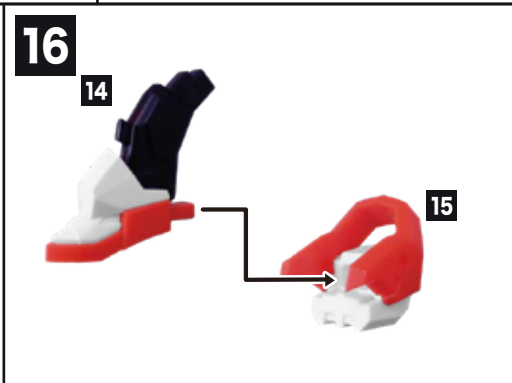
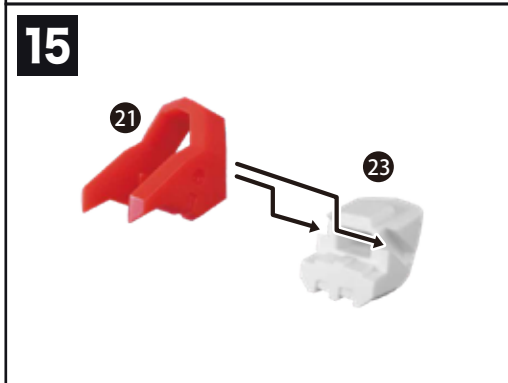
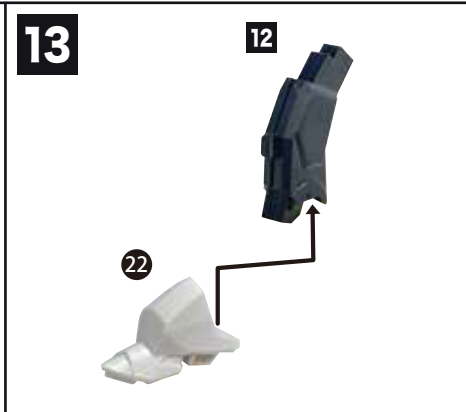
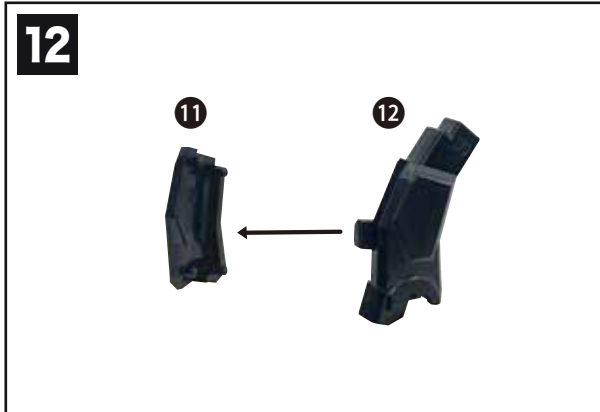

# I Assemble Right Leg Armor

1

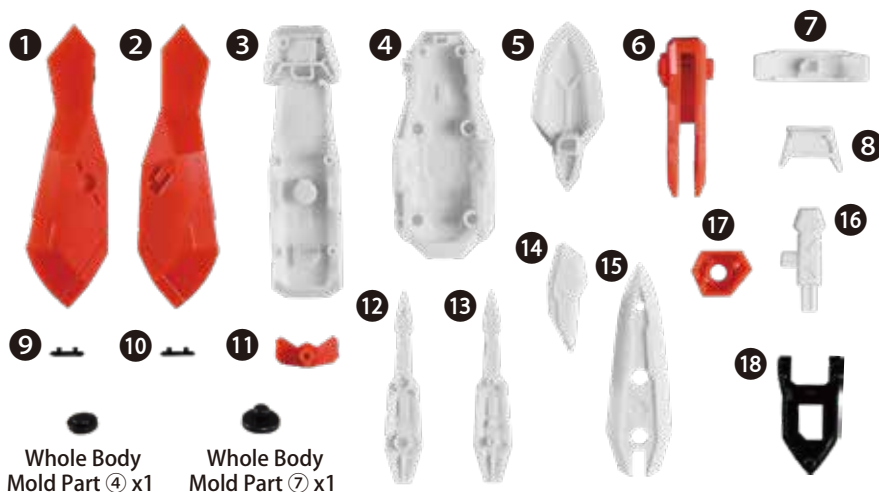

2

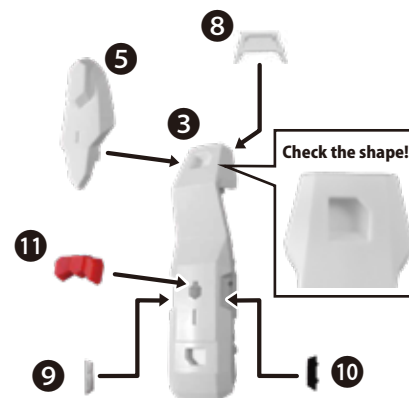

3

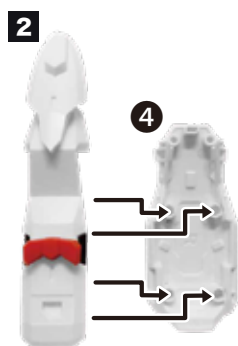

4

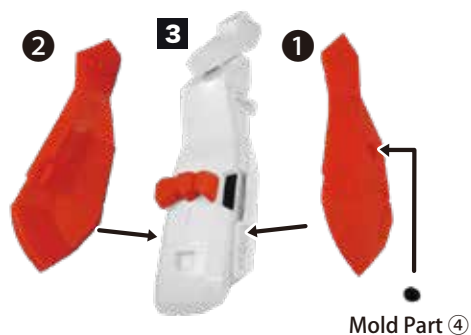

5

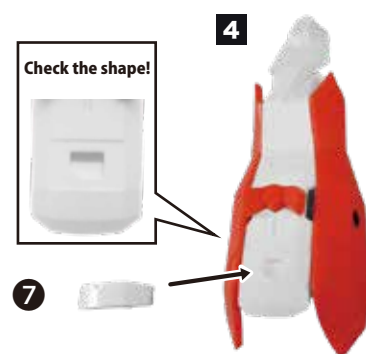

6



7

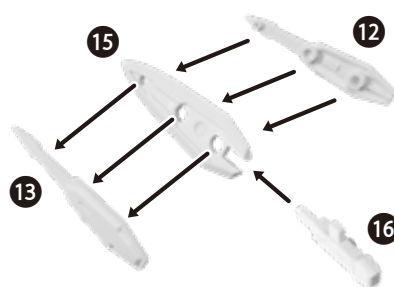

8

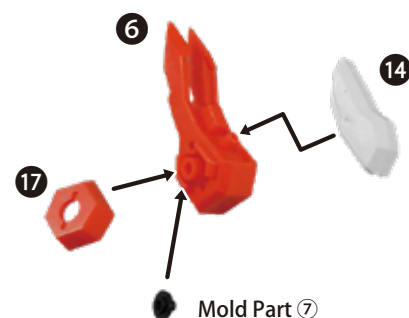

9

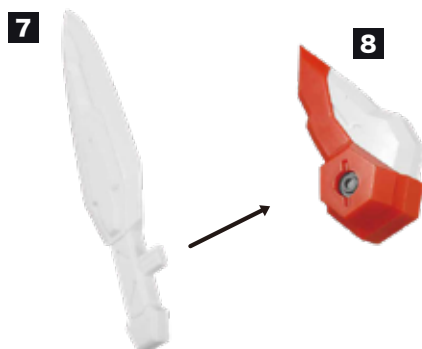

10

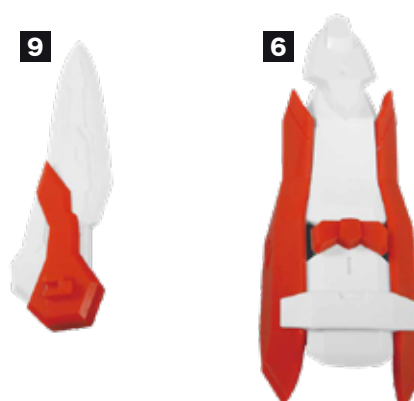

Assemble these parts last to allow for fine adjustments of their placements and angles.



## J Assemble Right Leg Sword

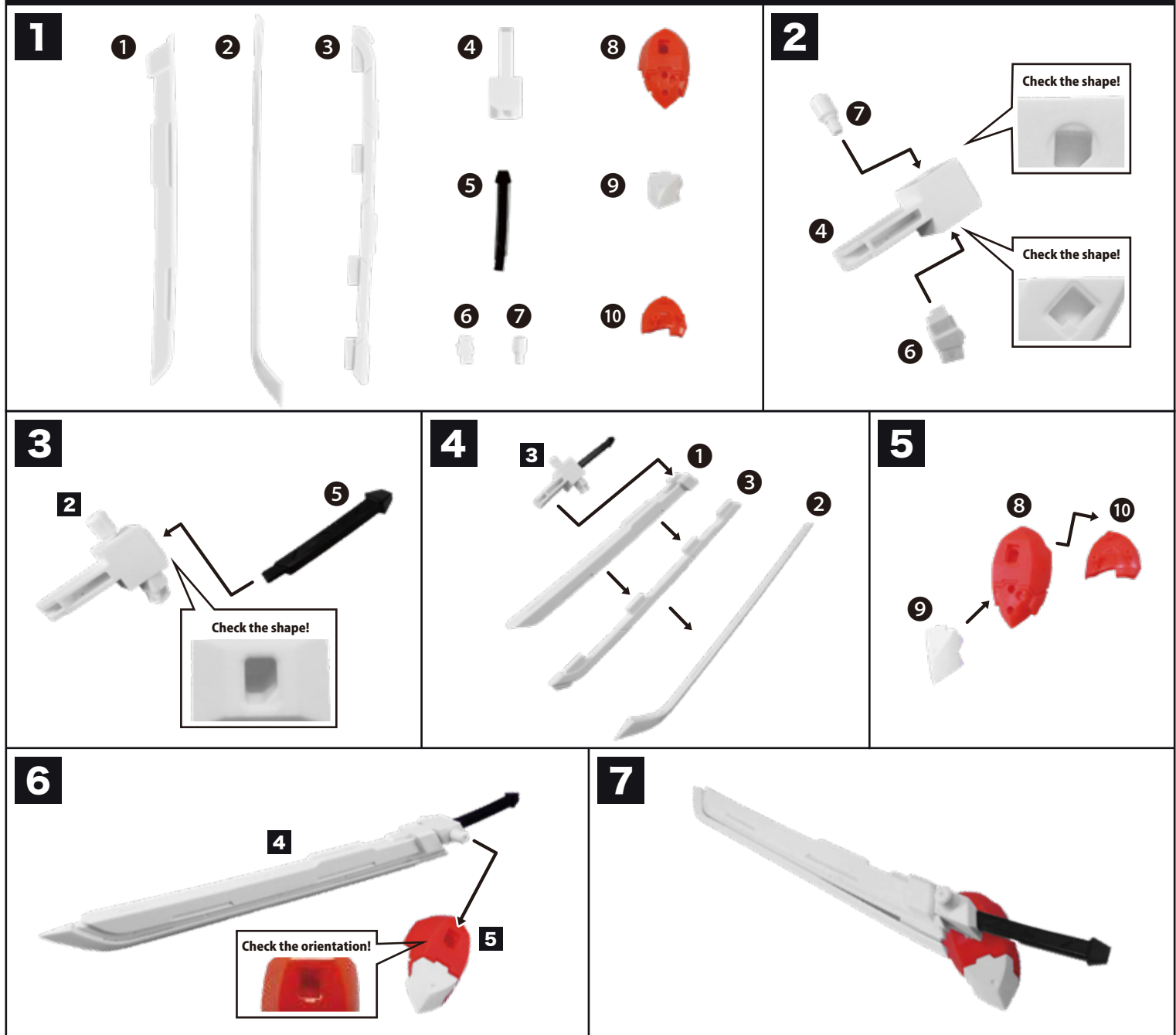

## K Assemble Left Leg 1

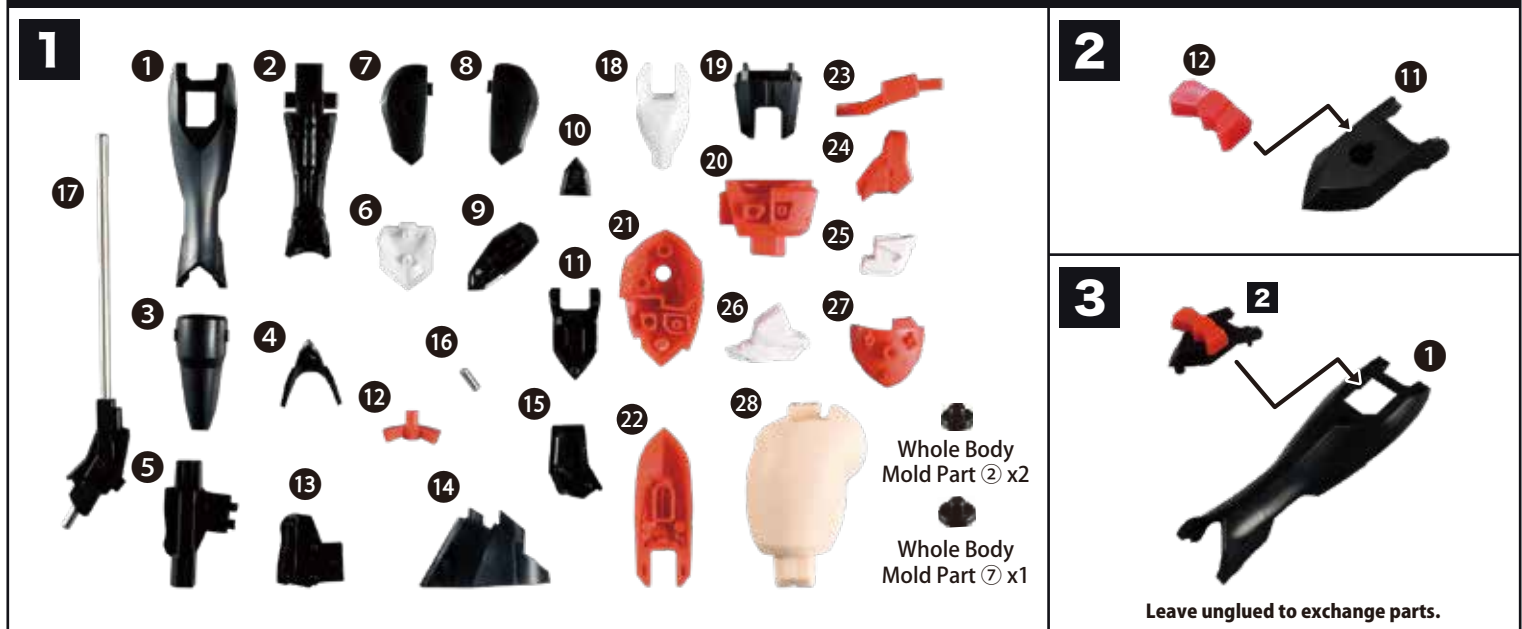

4

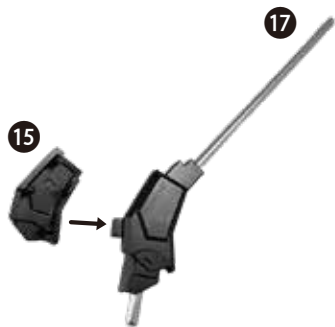

5

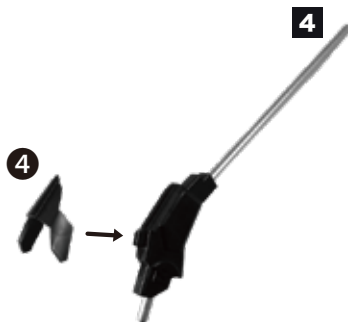

6

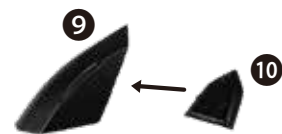

7

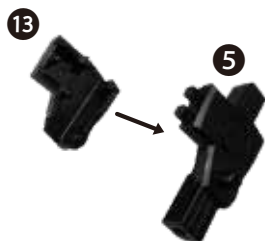

8



9

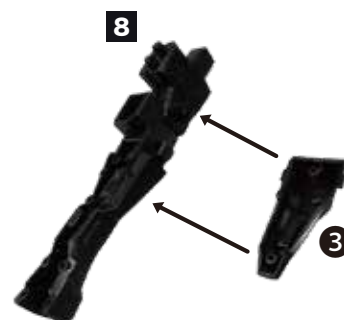

10

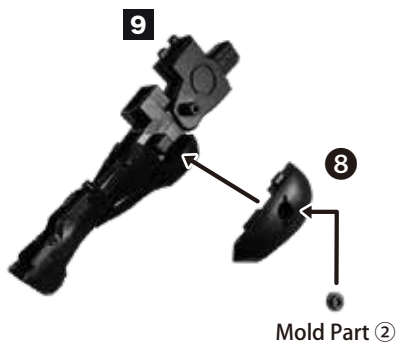

11

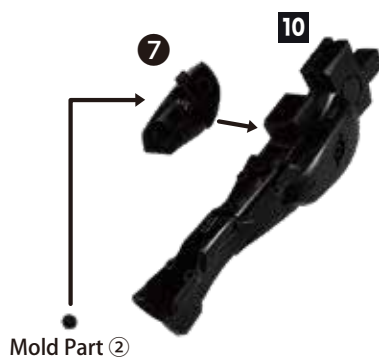

12



13

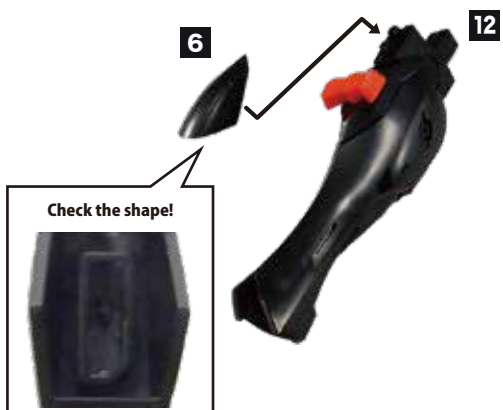

14

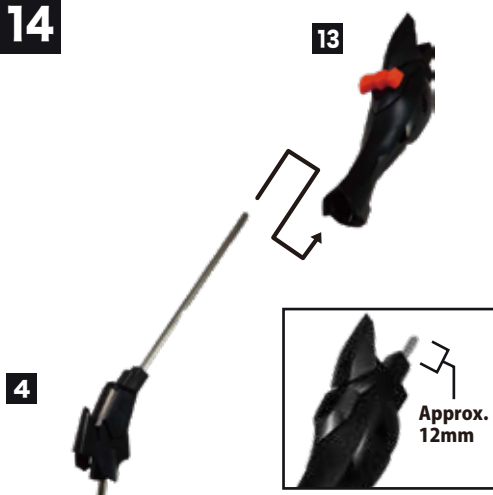

15



16

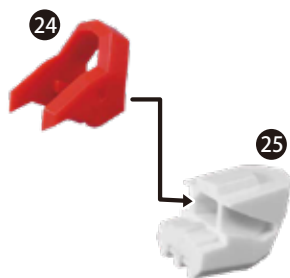

17

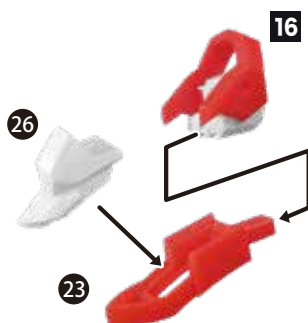

18



19



20

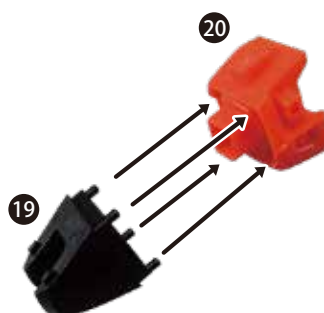

21

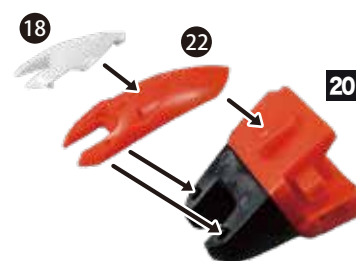

22

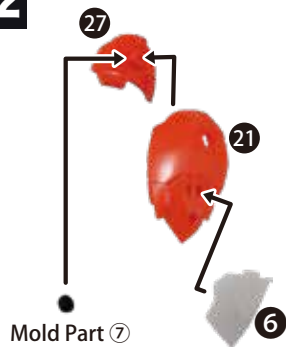

23



24

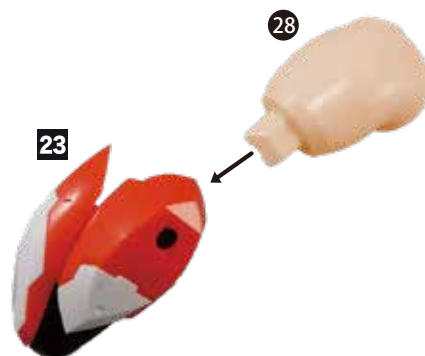

25



26



# L Assemble Left Leg Armor 1

1



2

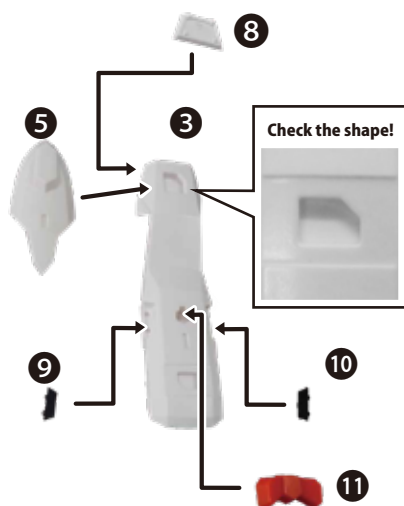

3



4

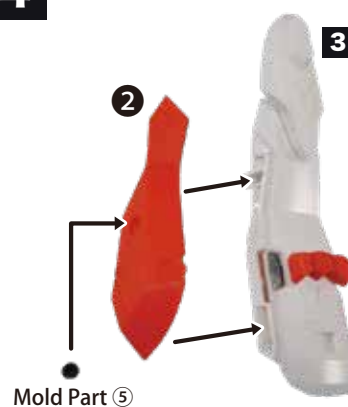

5



6

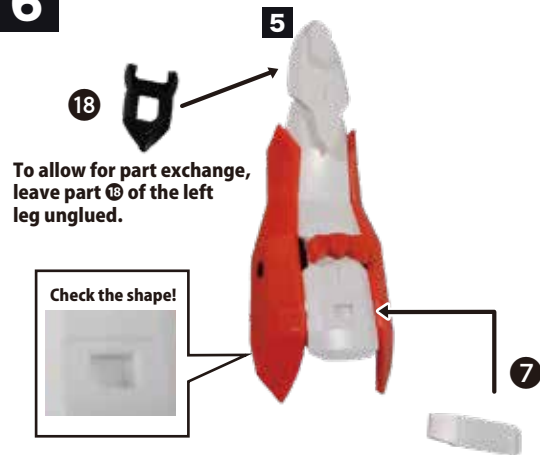

7

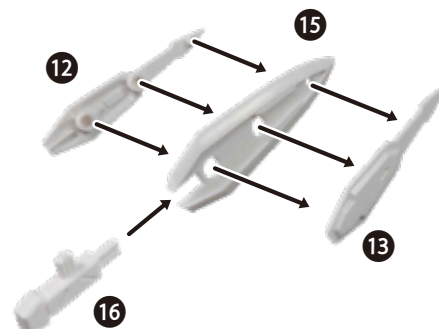

8

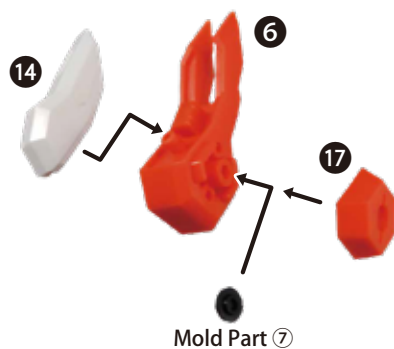

9

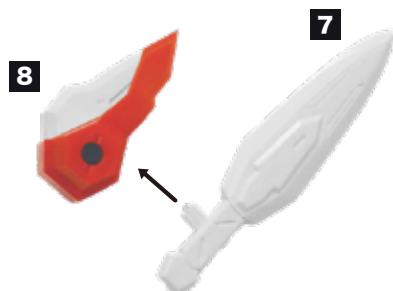

10

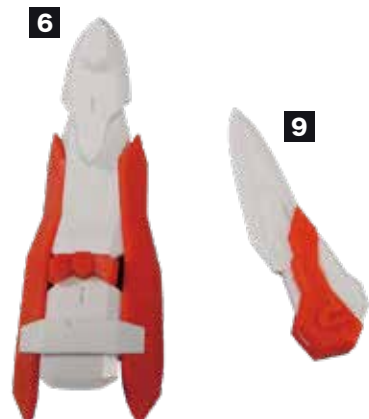

## M Assemble Left Leg 2

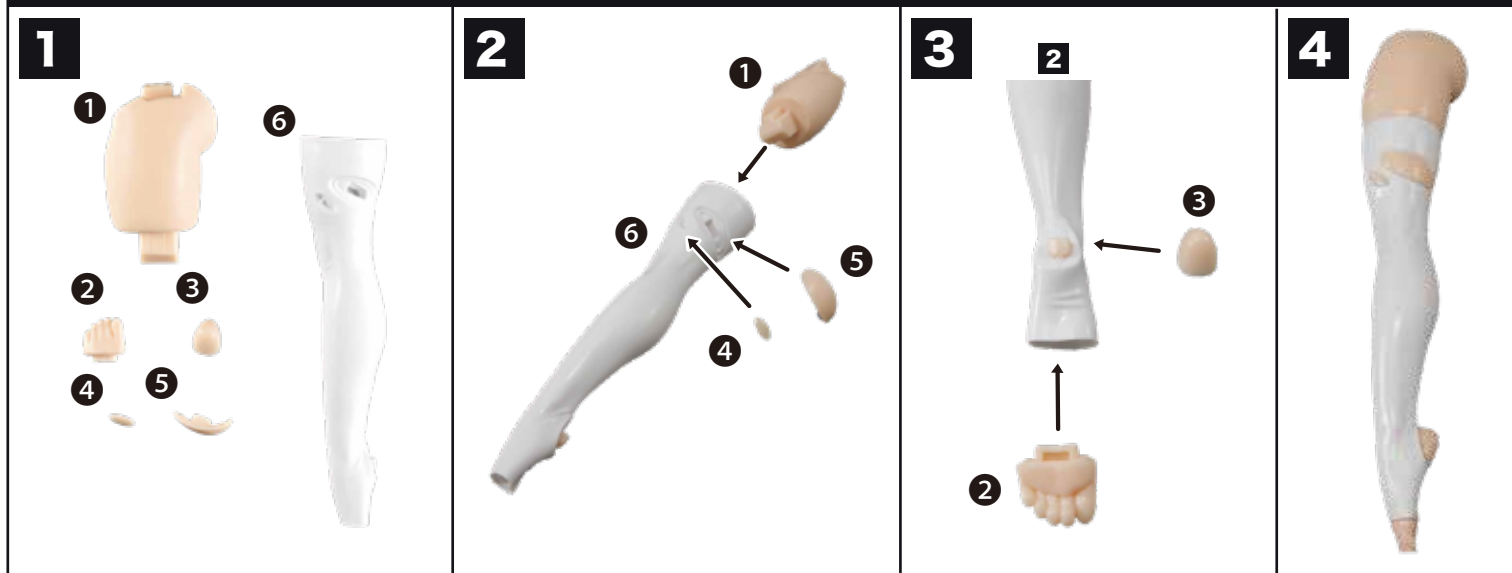

## N Assemble Weapons Steps 2 through 4 should be completed twice

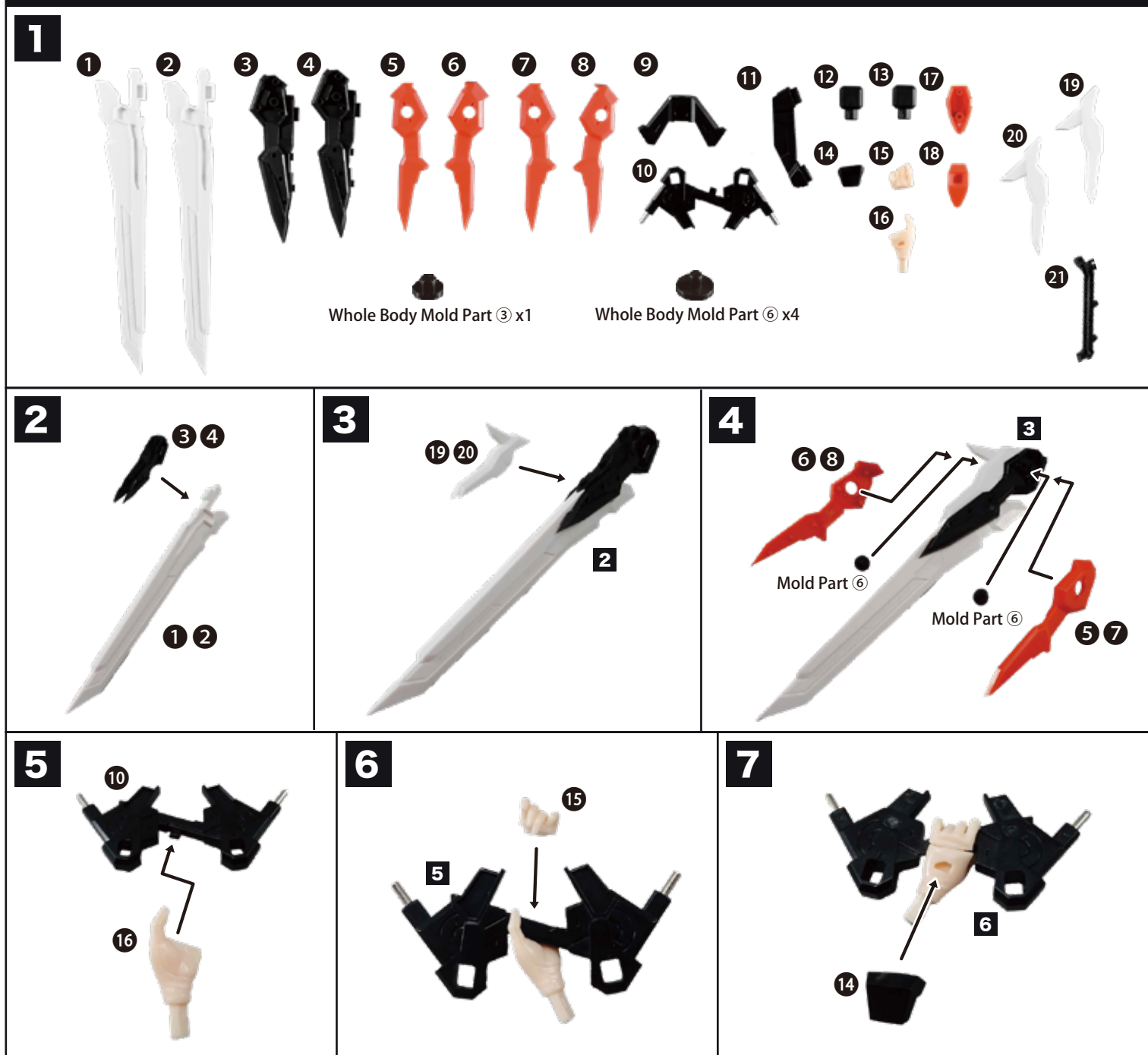

8

Mold Part ③

9

12

7

13

Check the shape!



Parts 12 and 13 are identical.

9

21

11

10

17

18

11

9

10

12

4

8

4

11

0 Assemble the Assemble Each Part

1

1

2

3

4

2

3

1

3

4

2



## P Completed Assembly



The above image shows parts left unglued to allow for exchange of parts. Assembled components shown can be glued together. Please adjust accordingly to create a complete model according to your preferences.

## Q How to Place on the Cushion Display Stand

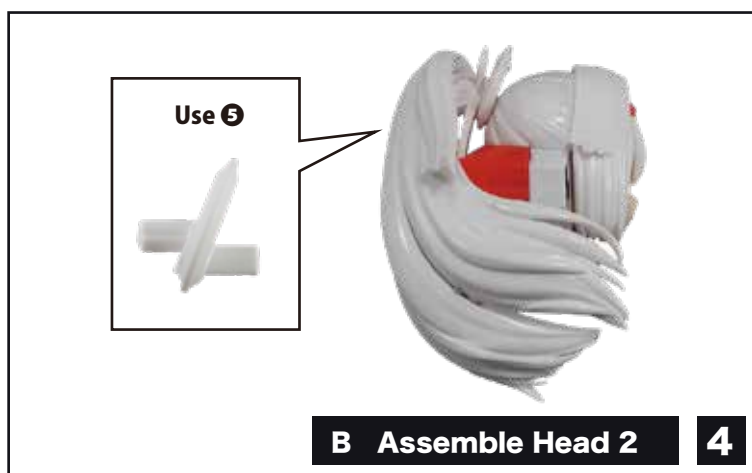

When placing the figure on the cushion display stand, please use angle part 5 to attach the rear hair part.

## R How to Attach to the Stand

First, insert the short shaft into the acrylic base.

Next, attach just the left leg to the base. The leg is placed on the support in the image shown.



Next, assemble the figure as shown below. Insert the long shaft into the acrylic base, then attach the figure to the left leg.



The figure is placed on the support in the image shown.

## S How to Assemble the Left Hand Weapon

Remove the 2 parts.

Attach the weapon.

Attach a support part to fix the weapon in place.

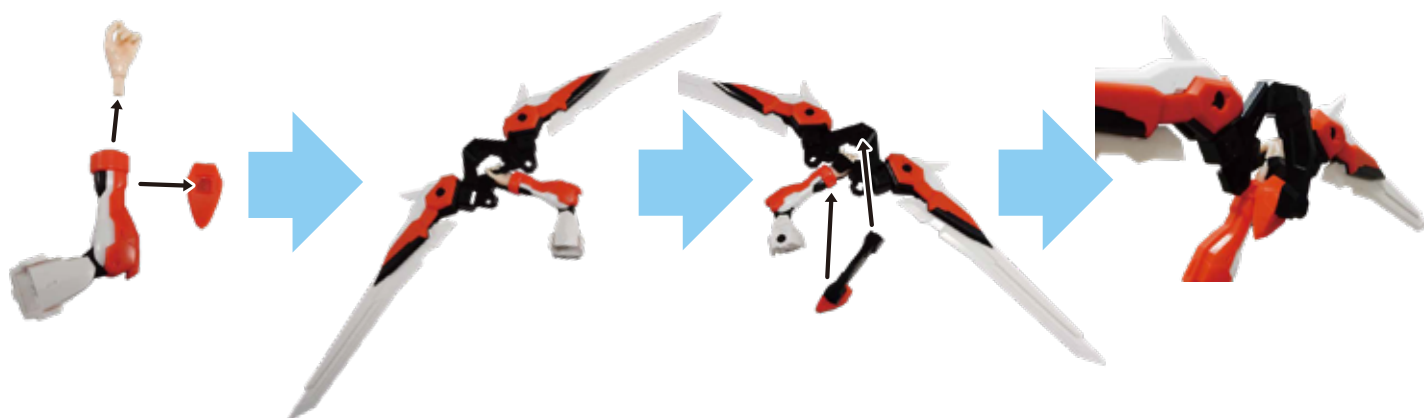



## T How to Assemble the Right Leg Weapon

Remove this part from the thigh, then attach the weapon.



Remove this part from the shin, then attach the weapon.

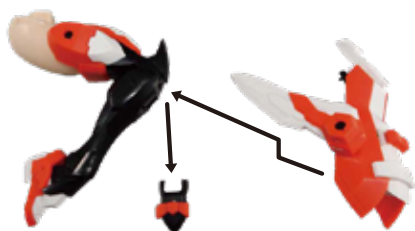

When both weapons are attached simultaneously, the parts will touch as shown in the image.

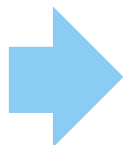

Therefore, adjust the angle at the section shown in the image to create a gap. If gluing this part, please take note of the angle.



## U How to Attach the Left Leg Weapon

Detach and attach the parts in numerical order.



# Attach Decals

Check the placement and attach the included decals according to the instructions that follow.

## ●水転写デカール

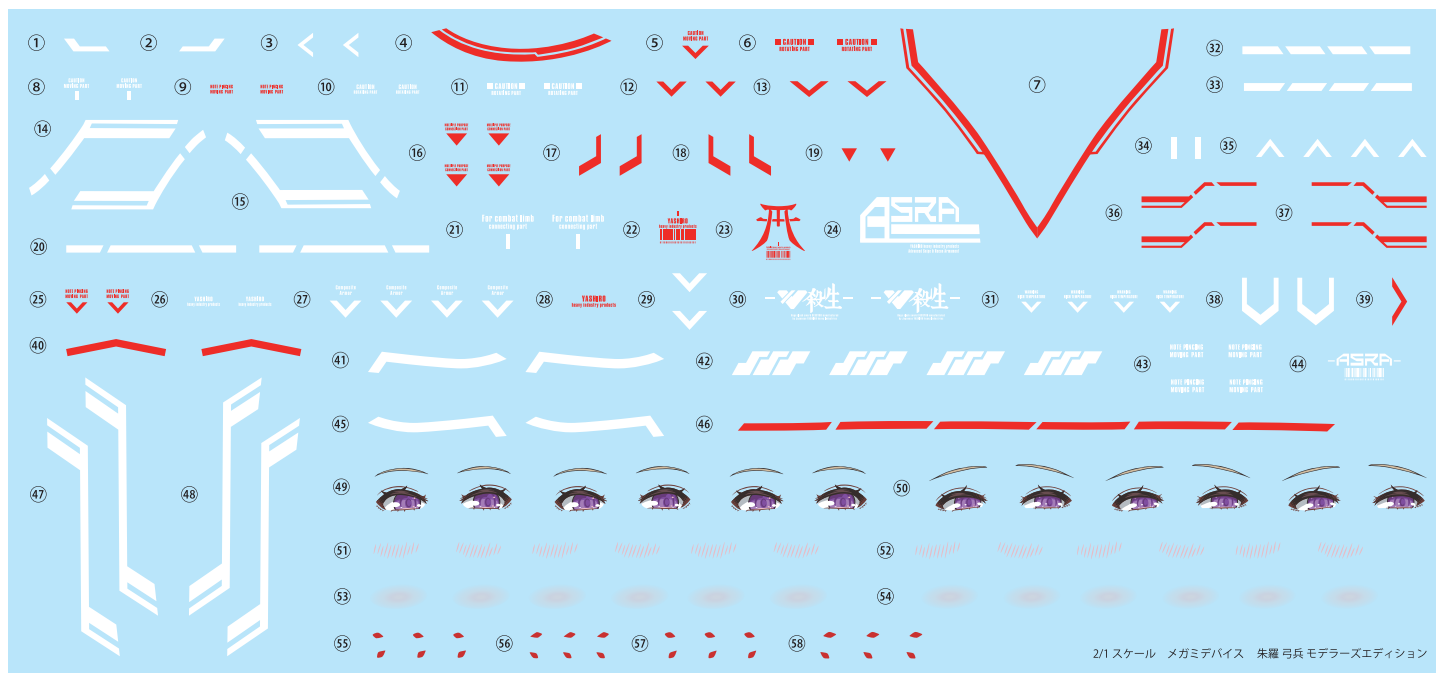

2/1 スケール メガミデバイス 朱羅弓兵 モデルズエディション

## Attaching Decals

- Prepare scissors or a hobby knife, tweezers, and cotton swabs.
- The decal sticks on easily if the oil on the sticky part is removed with detergent first.



**Do not touch the decal until it has dried completely.**

- ① Cut the decal and backing with scissors or a hobby knife.
- ② Float the decal in cold or lukewarm water for 10 seconds and then remove with tweezers.
- ③ Remove the decal from the backing and attach while adjusting the position.
- ④ Gently push on the decal with the cotton swab to remove remaining water. It is complete when the decal is completely dry.

- Decals cannot be attached to rough surfaces or surfaces that absorb water (i.e. rough, unpainted wooden products).
- To remove a mistakenly attached decal, place a thoroughly wet towel over it for 10 minutes and lightly rub the decal off.

### (Tips for Attaching Decals to Curved Surfaces)

Decals attach smoothly to curved surfaces when softened first with decal softener (sold separately). Additionally, through the use of surface finishing spray (sold separately), the decal will be more resistant to ripping or tearing.

"When removing and attaching parts to your model, make sure to not touch the surface you have attached the decal to.

"Decals rip easily after the use of decal softener. Make sure to not touch the decal until it has fully dried. If a white space appears, you can either cut it out along the shape of the part, or fold it to the inside.

"When using decal softener and surface finishing spray, make sure to follow the product's directions.

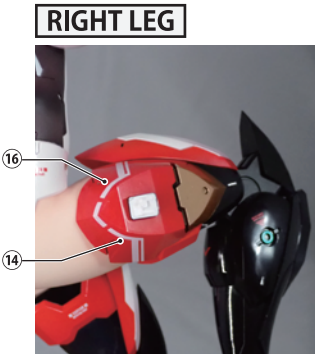
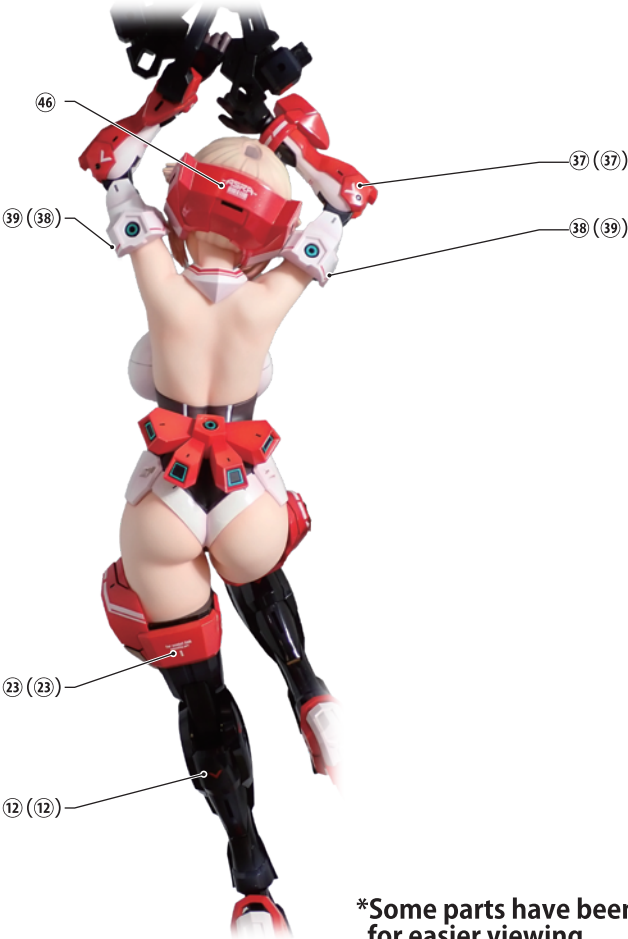
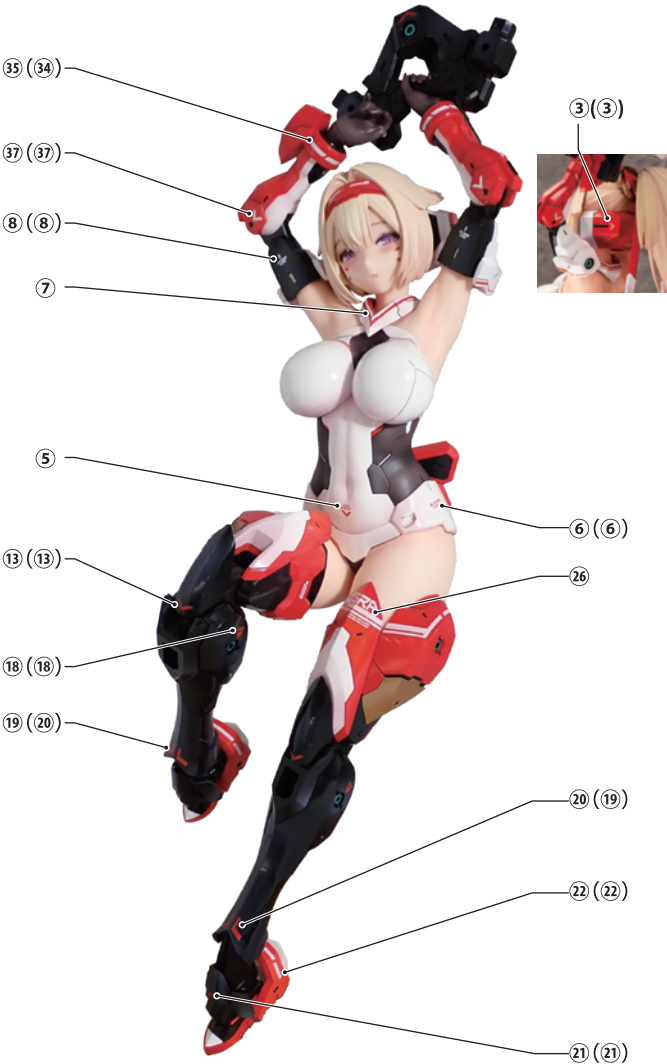

\*Some parts have been removed for easier viewing.

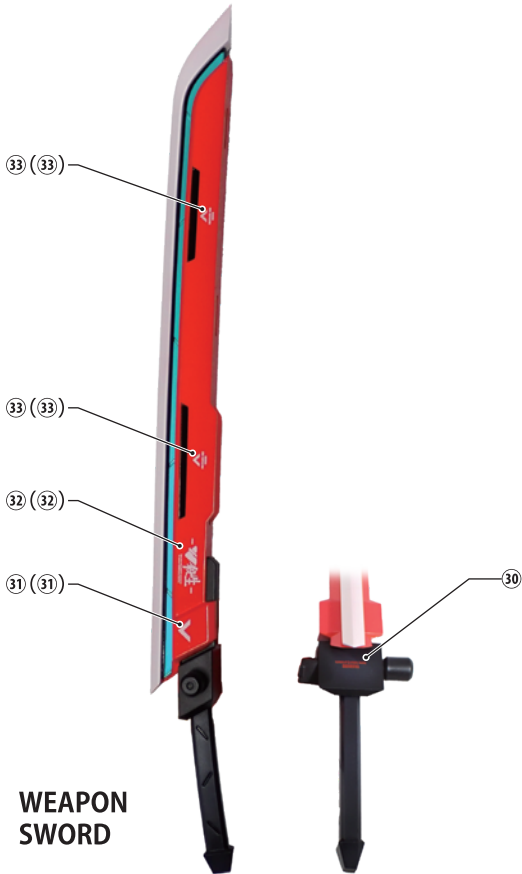

WEAPON  
SWORD

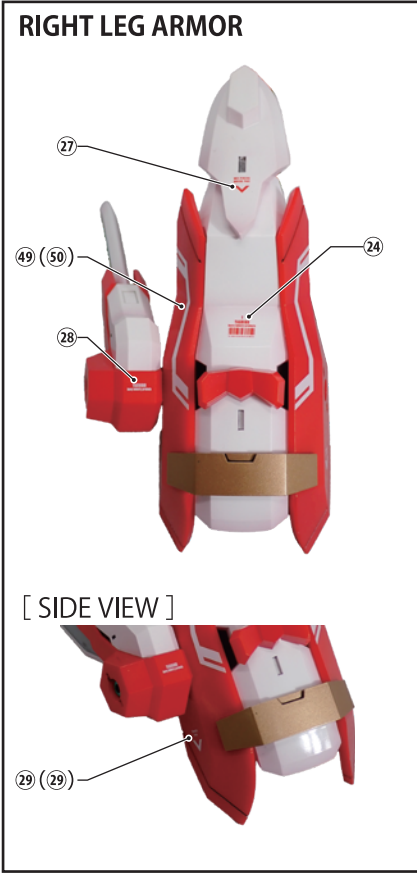

RIGHT LEG ARMOR

[ SIDE VIEW ]

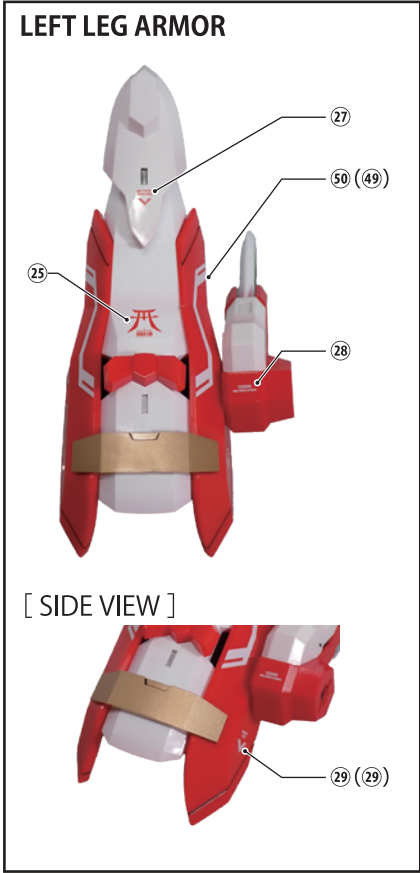

LEFT LEG ARMOR

[ SIDE VIEW ]

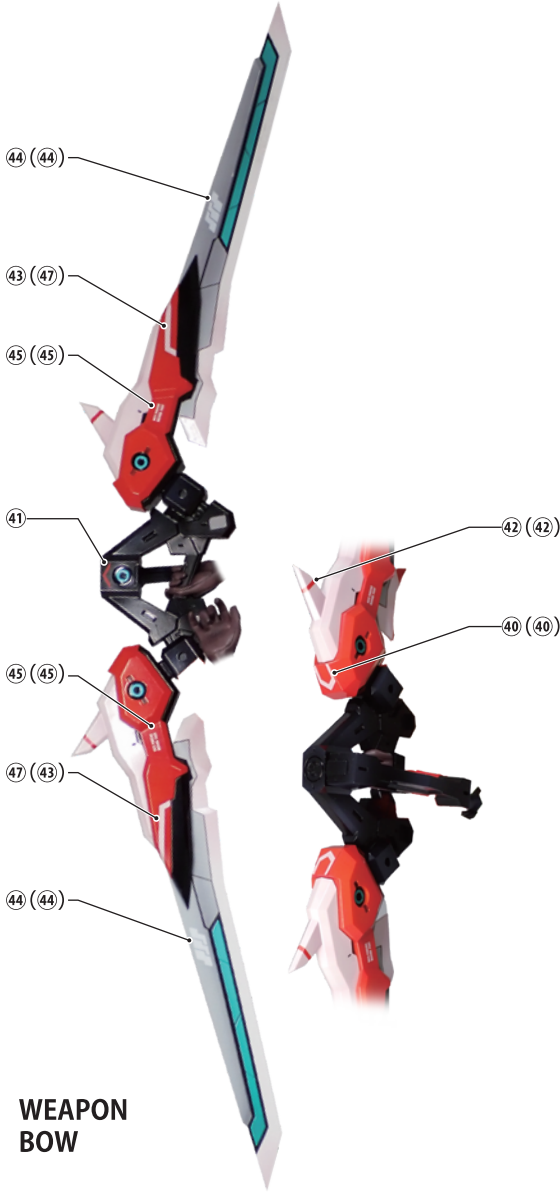

WEAPON  
BOW

